

7

**NOTICE OF MEETING – COMMISSIONERS COURT**  
**RAINS COUNTY, TEXAS**

Notice is hereby given that a **SPECIAL MEETING** of the Rains County Commissions court will be held at **1:00 p.m. on Tuesday, April 16, 2024** in the Rains County Courthouse Courtroom. The subjects to be discussed or considered or upon which any formal action may be taken are as follows:

I. ITEMS FOR DISCUSSION and/or ACTION

A. Discuss/take action regarding Declaring an Emergency Bridge Repair on CR 1150 and funding it. 6

III. Administrative Court Activities and Comments

During the course of the meeting covered by this notice, should the court determine that a closed or executive meeting or session of the Court be required, then such closed or executive meeting or session as authorized by Section 551.071 through 551.076 of the Texas Government code shall be held by the Court at the date, hour, and place given in this notice or shortly thereafter. Sections (551.071 – Consult With an Attorney); (551.072 – Real Property); (551.073 – Prospective Gifts); (551.074 – Personnel Matters); (551.075 – Conference Relating to Investments); (551.076 – Security Devices).

Note: Notice posted in compliance with the Texas Open Meetings Act, Chapter 551 of the Texas Government Code

  
\_\_\_\_\_  
County Judge Linda Wallace

FILED FOR RECORD

2024 APR 11 AM 11:45

MANDY SAWYER  
COUNTY CLERK  
RAINS COUNTY, TEXAS  
BY 

THE STATE OF TEXAS

§  
§  
§  
§  
§

RAINS COUNTY

COMMISSIONERS

COUNTY OF RAINS

COURT

**April 16, 2024**

Be it remembered, the Commissioners Court of Rains County, Texas, this **Special Meeting** being convened in the Rains County Courthouse, on **Tuesday, the 16th day of April 2024**, at **1:00 p.m.** with the following members of the court being present:

**County Judge Linda Wallace**  
**County Commissioner Mike Willis**  
**County Commissioner Jeremy Cook**  
**County Commissioner Lori Northcutt**

Taped proceedings of court duly transcribed by:

**Mandy Sawyer**  
**County Clerk/Court Ex-officio**

The agenda was prepared by the Judge's office announcing a special meeting to be held by the Commissioners at **1:00 p.m. on Tuesday, April 16, 2024.**

The posted meeting of the Commissioners Court was held at **1:00 p.m. on Tuesday, the 16<sup>th</sup> day of April, 2024.**

**I. OPEN FORUM**

**II. ITEMS FOR DISCUSSION**

**A. Discuss/take action regarding declaring an emergency bridge repair on CR 1150 and funding it.**

Moved by Commissioner Mike Willis duly seconded by Commissioner Lori Northcutt to declare the culvert on CR 1150 an emergency repair and replace with the box culvert.

Court Members Voting Aye: Mike Willis, Lori Northcutt, Linda Wallace and Jeremy Cook.

Court Members Voting No: None  
Court Members Abstaining: None  
Motion Carried.

Moved by Commissioner Mike Willis duly seconded by Commissioner Lori Northcutt to fund replacing damaged culvert with a box culvert by moving funds over from contingency funds.

Court Members Voting Aye: Mike Willis, Lori Northcutt, Linda Wallace and Jeremy Cook.

Court Members Voting No: None  
Court Members Abstaining: None  
Motion Carried.

**III. Administrative Court Activities and Comments.**

With further business to discuss, the court was recessed at 1:12 p.m. and will reconvene at 2:00 p.m.

On this the 16<sup>th</sup> day of April 2024, I, Mandy Sawyer, attest to the accuracy of this record.

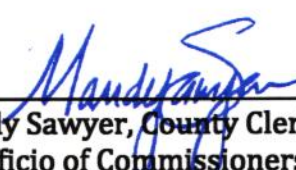

  
\_\_\_\_\_  
**Mandy Sawyer, County Clerk &  
Ex-officio of Commissioners Court**

TO: RAINS COUNTY  
 FROM: BAHENA CONSTRUCTION CO., INC.  
 \*\*\*DBE CERTIFIED\*\*\*

PROJECT: RAINS COUNTY CR 1150  
 When done with 1301  
 LETTING DATE: APRIL 2024

ITEM NO.	DESC. CODE	S.P. NO.	DESCRIPTION	UNIT	ESTIMATE	PRICE	TOTAL
400			CUT & RESTORING PAV	SY	25.00	\$ 300.00	\$ 7,500.00
462			CONC BOX CULV (8' X 8')	LF	22.00	\$ 2,000.00	\$ 44,000.00
466			WINGWALL PW-1(HW= 9')	EA	2.00	\$ 30,000.00	\$ 60,000.00
496			REMOV EXIST STRUCTURE	EA	2.00	\$ 1,000.00	\$ 2,000.00
500			MOBILIZATION	LS	1.00	\$ 5,000.00	\$ 5,000.00
			<b>TOTAL</b>				<b>\$ 118,500.00</b>

\*NOTES\* 1) NO BARRICADES OR TRAFFIC CONTROL  
 2) NO ENGINEER WORK  
 3) NO BONDING  
 4) NO TEMPORARY/SPL SHORING

SUBMITTED BY:

CBEXUM

ACCEPTED BY:

\_\_\_\_\_





NOV

April 15, 2024

Mr. Ronnie Morgan  
Rains County

RE: Rains County Roads 1150 and 2420 Bridge Replacements

Dear Mr. Morgan,

Archer Construction has reviewed the on-site condition in Rains County at County Roads 1150 and 2420 south and southeast of Emory. We have assembled costs below for the replacement of each individual bridge with clarifications on the scope of work we will be providing. Our TIPS contract vendor number is 230104. Archer Construction's UEI Number is MTPYVSKR85.

Proposed Cost Bridge CR 1150 (CR 1150 Includes 7 each W30 x 90 x 50 Ft for greater distance)	\$ 200,139
Proposed Cost Bridge CR 2420 (CR 2420 includes 40'-0 x 20'-0 width clear bridge)	\$ 167,807
<b>Total if Both Accepted</b>	<b>\$ 367,946</b>

Included in this cost is the following:

- Land clearing and earth excavations that are necessary for new bridge construction.
- Backfill, build new back slopes, and any necessary dirt work to complete project.
- County will provide backfill material including rock and earth fill to contractor for use for back slopes.
- Remove existing steel from existing bridge and retain steel for contractor salvage.

#### General Clarifications & Exclusions

- County is responsible for rebuilding and paving approaches from existing roadway on each side of new bridge.
- County is to obtain any landowner permissions and right of way acquisitions as needed to start and complete project.
- County is responsible for road closures, bridge out barricades and traffic detours and notifications.
- County is responsible for hauling and disposal of any materials, debris, trees, and brush from construction of bridges.
- We have included a payment and performance bond.
- We have included TIPS fee.
- Tax is not included.
- We have not included any costs for any major site grading, drainage, or utility relocation.
- We have not included any materials testing. Costs for materials testing lab would need to be carried by the ISD.
- We assume that there are no hazardous materials on the site and have not included any costs for testing or remediation.

We sincerely appreciate the opportunity to provide this quote to Rains County and look forward to the possibility of working together. We are available to discuss any scope to help you make the right decisions for your project.

Thank you,

Travis Frank  
Archer Construction & Design  
903-739-2350

SCALE: N.T.S.

50'-0" Overall for CR 1150

40' OVERALL LENGTH

20'

"X" BRACING (5)

24'

20'-0" Overall for CR 2420

PLAN VIEW

7-W24x68 AT 48" SPACING

5" THICK REINF CONC DECK (1) WITH #4 BARS AT 12" C.C.-B-W

7-W24x68 AT 48" SPACING

W10x68

W10x33

W10x68

W10x33

10' MAX EXPOSED PILE LENGTH

SEE DETAIL "A"

5"x3"x1/4" ANGLE

BACKWALL (SHEET PILING)

W10x68 CAP

W10x33 PILE

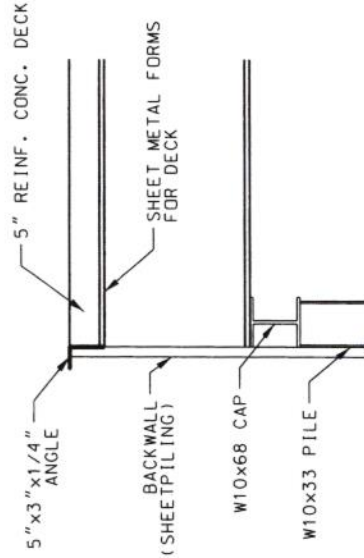

DETAIL "A" ABUTMENT

(4)

(4)

PROFILE VIEW

- DESIGN LOADING: HS-20
- DESIGN LOADING APPLIED TO ALL STEEL MEMBERS OF THE SUPERSTRUCTURE AND SUBSTRUCTURE ONLY. THE DECK AND BEARING CAPACITY OF THE PILES ARE NOT INCLUDED.
1. ALL STRUCTURAL STEEL SHALL BE A36. CONCRETE SHALL HAVE A MINIMUM COMPRESSIVE STRENGTH OF 3500 PSI.
  2. PLACE ABUTMENT "W" PILES WITH STRONG AXIS PERPENDICULAR TO ABUTMENT ALIGNMENT.
  3. WELD ALL STEEL MEMBER CONNECTIONS.
  4. FOUNDATION/PILE EMBEDMENT DEPTHS ARE NOT DETERMINED.
  5. PLACE "X" BRACING BETWEEN STRINGERS AT MID-SPAN WITH 2"x2"x3/16" ANGLES OR SIMILAR.

SCALE: N.T.S.

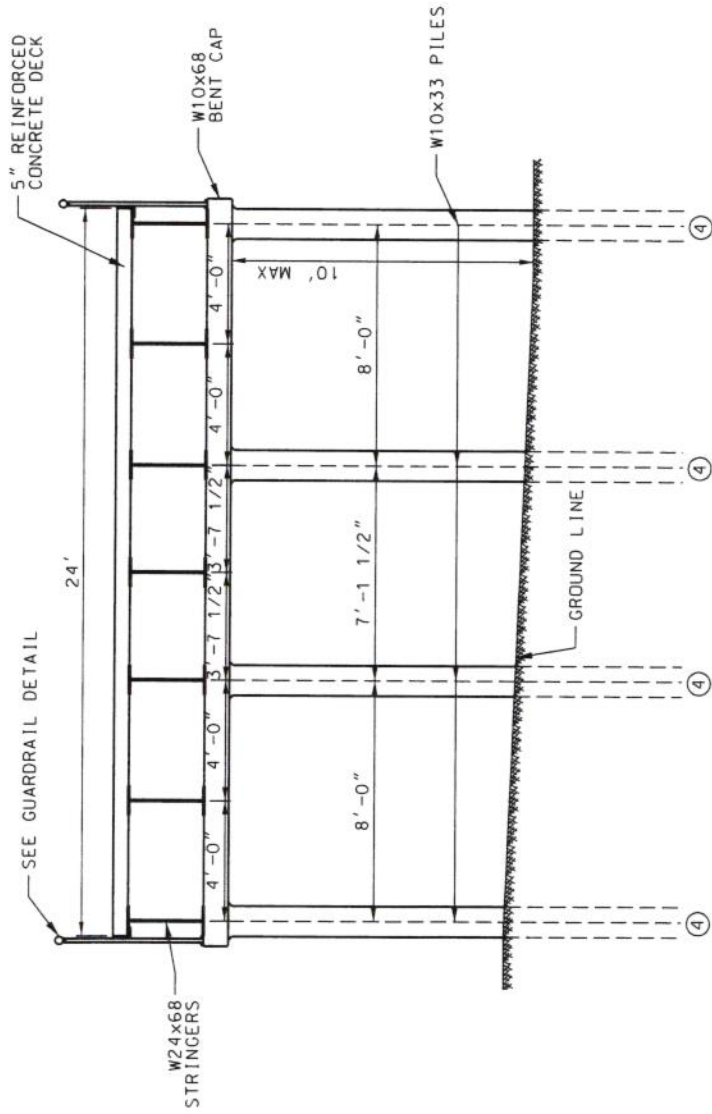

ABUTMENT SECTION

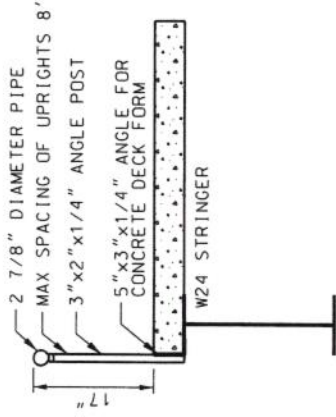

GUARDRAIL DETAIL

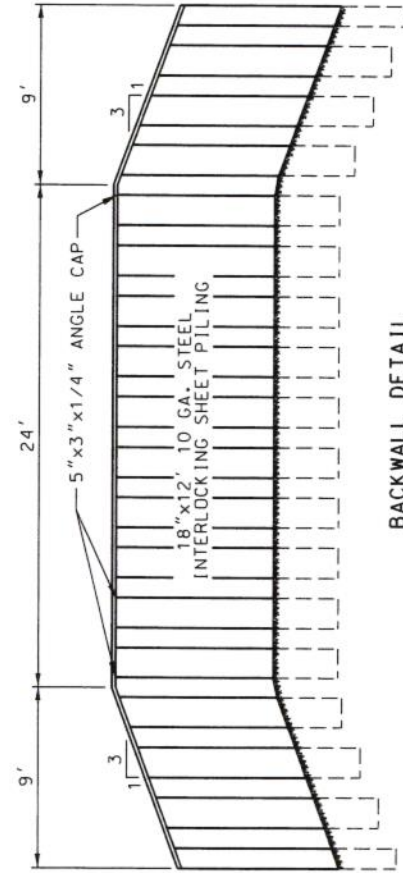

BACKWALL DETAIL

BRIDGE CONSTRUCTION PLANS

PLAN AND PROFILE

PROJECT #:

CONTRACT #:

DATE: 11/27/2021

DRAWN: JMM

USER: BRIDGE

SHEET 2 OF 2